

UNSLOTTED INDENTED HEX HEAD MACHINE SCREW

XXXXUHMZ
APRIL, 2014
REV 00
PAGE 1 of 1

Nominal Screw Size	#0 Thru #12	1/4 Thru 3/4
Nominal Screw Length	Tolerance	
Up To & Including 1/2"	-0.02	-0.03
Over 1/2 To 1", Inclusive	-0.03	-0.03
Over 1" to 2", Inclusive	-0.06	-0.06
Over 2"	-0.09	-0.09

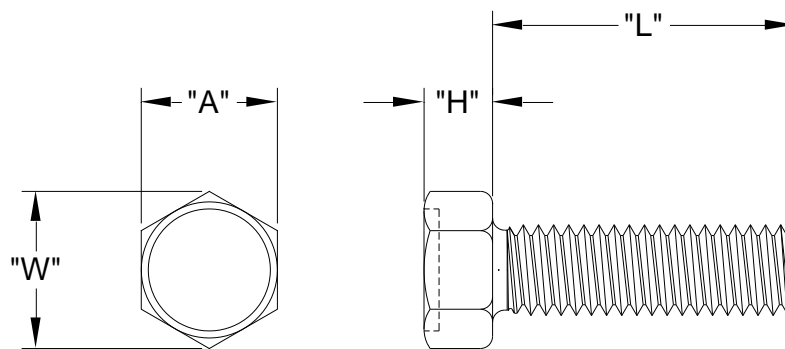

Nominal Screw Size	Basic Screw Size	Major Diameter		"A"		"W"	"H"	
				Width Across Flats		Width Across Corners	Head Height	
		Max.	Min.	Max.	Min.	Min.	Max.	Min.
#10 - 24	0.190	0.1900	0.1818	0.312	0.305	0.340	0.120	0.105
#10 - 32		0.1900	0.1831					
1/4 - 20	0.250	0.2500	0.2408	0.375	0.367	0.409	0.190	0.172
5/16 - 18	0.313	0.3125	0.3026	0.500	0.489	0.545	0.230	0.208

Standard: ASME B18.6.3 Material: Carbon Steel, 60,000 psi Minimum Tensile Stress Finish: Commercial Zinc & ROHS Compliant Clear Chromate Per ASTM F1941 Code Fe/Zn 3A	Common Uses: Nuts, Tapped Holes, Threaded Inserts Most economical of the hex profile heads; Most commonly used with sems washers
--	--