

SLOTTED INDENTED
HEX WASHER HEAD
TYPE "AB" S.M.S.

XXXXSHWABZ
June, 2017
REV 01
PAGE 1 of 1

Nominal Screw Length	Tolerance On Screw Length
Up To & Including 1"	± .030
Over 1"	± .050

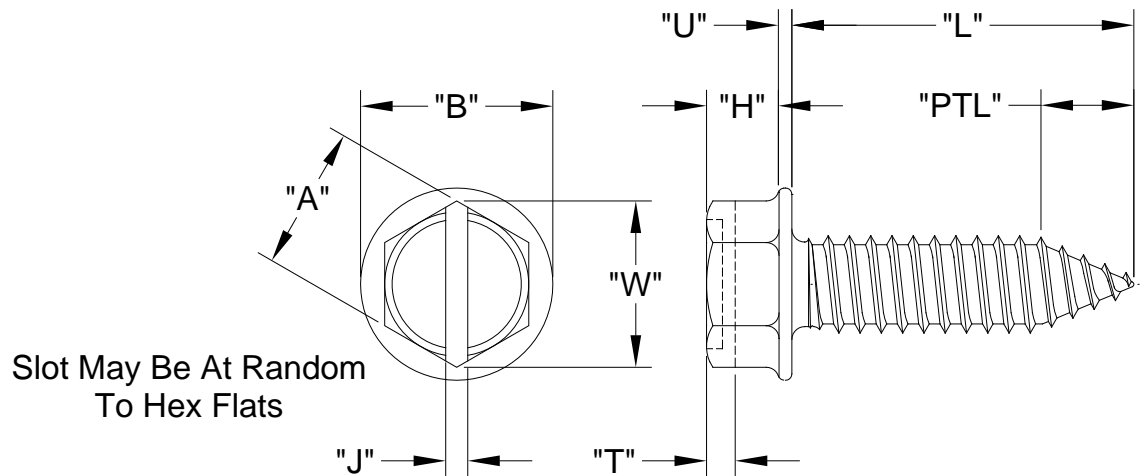

Nominal Screw Size	"D"		"d"		"PTL"	Minimum Practical Screw Length	"A"		"W"	"H"		"B"		"U"		"J"		"T"	
	Major Diameter		Minor Diameter		Point Taper Length		Width Across Flats		Width Across Corners	Head Height		Washer Diameter		Washer Thickness		Slot Width		Slot Depth	
	Max.	Min.	Max.	Min.	Ref.		Max.	Min.	Min.	Max.	Min.	Max.	Min.	Max.	Min.	Max.	Min.	Max.	Min.
#4-24	0.114	0.108	0.086	0.082	0.160	7/32	0.188	0.181	0.202	0.060	0.049	0.243	0.225	0.019	0.011	0.039	0.031	0.042	0.025
#6-20	0.139	0.132	0.104	0.099	0.193	9/32	0.250	0.244	0.272	0.093	0.080	0.328	0.302	0.025	0.015	0.048	0.039	0.053	0.033
#7-19	0.154	0.147	0.115	0.109	0.211	5/16	0.250	0.244	0.272	0.093	0.080	0.328	0.302	0.029	0.017	0.048	0.039	0.053	0.033
#8-18	0.166	0.159	0.122	0.116	0.209	5/16	0.250	0.244	0.272	0.110	0.096	0.348	0.322	0.031	0.019	0.054	0.045	0.074	0.052
#10-16	0.189	0.182	0.141	0.135	0.256	3/8	0.312	0.305	0.340	0.120	0.105	0.414	0.384	0.031	0.019	0.060	0.050	0.080	0.057
#12-14	0.215	0.208	0.164	0.157	0.297	7/16	0.312	0.305	0.340	0.155	0.139	0.432	0.398	0.039	0.022	0.067	0.056	0.103	0.077
1/4-14	0.246	0.237	0.192	0.185	0.335	1/2	0.375	0.367	0.409	0.190	0.172	0.520	0.480	0.050	0.030	0.075	0.064	0.111	0.083

Standard: ASME B18.6.3
Material: Carbon Steel,
Heat Treat: Case Hardened
Finish: Commercial Zinc, Bake & ROHS Compliant Clear Chromate
Per ASTM F1941 Code Fe/Zn 3A

Common Uses:
Increased Bearing Surface w/o Adding A Washer.
Excellent For Softer Materials To Reduce Embedment;
Used In Soft Plastics, Soft Woods, Thin Sheet
Metal(<60% Of Major Dia.), Aluminum Extrusions