

COMBINATION TYPE 1 CROSS RECESS / SLOTTED PAN HEAD MACHINE SCREW

XXXXCPMZ
APRIL, 2014
REV 00
PAGE 1 of 1

Nominal Screw Size	#0 Thru #12	1/4 Thru 3/4
Nominal Screw Length	Tolerance	
Up To & Including 1/2"	-0.02	-0.03
Over 1/2 To 1", Inclusive	-0.03	-0.03
Over 1" to 2", Inclusive	-0.06	-0.06
Over 2"	-0.09	-0.09

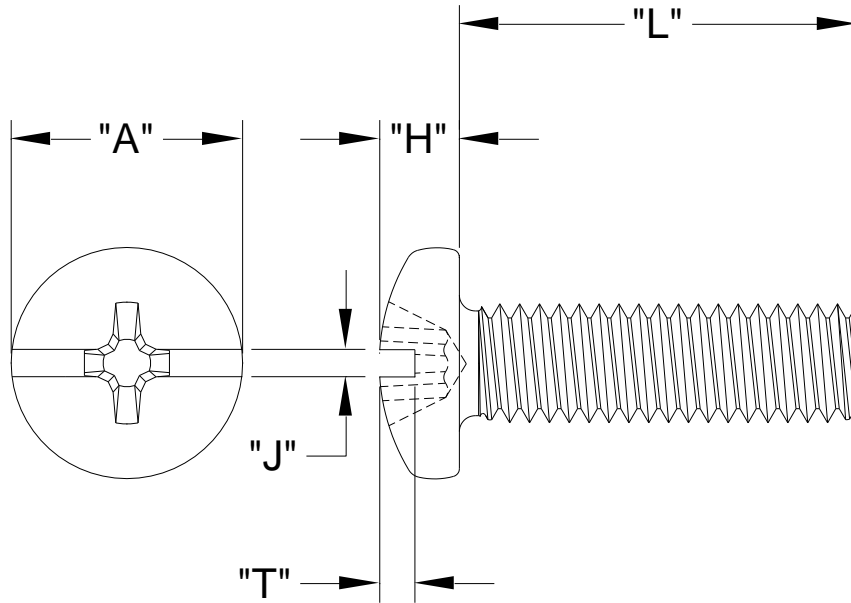

Nominal Screw Size	Basic Screw Size	Major Diameter		"A"		"H"		"J"		"T"		Driver Size	Recess Penetration Gaging Depth	
		Max.	Min.	Head Diameter		Head Height		Slot Width		Slot Depth			Max.	Min.
				Max.	Min.	Max.	Min.	Max.	Min.	Max.	Min.			
#4 - 40	0.112	0.1120	0.1061	0.219	0.205	0.080	0.070	0.039	0.031	0.040	0.027	1	0.071	0.053
#6 - 32	0.138	0.1380	0.1312	0.270	0.256	0.097	0.087	0.048	0.039	0.050	0.033	2	0.080	0.055
#8 - 32	0.164	0.1640	0.1571	0.322	0.306	0.115	0.105	0.054	0.045	0.058	0.041	2	0.097	0.071
#10 - 24	0.190	0.1900	0.1818	0.373	0.357	0.133	0.122	0.060	0.050	0.068	0.048	2	0.113	0.089
#10 - 32		0.1900	0.1831											
#12 - 24	0.216	0.2160	0.2078	0.425	0.407	0.151	0.139	0.067	0.056	0.077	0.055	3	0.124	0.098
1/4 - 20	0.250	0.2500	0.2408	0.492	0.473	0.175	0.162	0.075	0.064	0.087	0.063	3	0.144	0.118

Standard: ASME B18.6.3 Material: Carbon Steel, 60,000 psi Minimum Tensile Stress Finish: Commercial Zinc & ROHS Compliant Clear Chromate Per ASTM F1941 Code Fe/Zn 3A	Common Uses: Nuts, Tapped Holes, Threaded Inserts Most common head style; Higher head height for strength
--	---